



Grangemoor Close

Darlington DL1 4UW

£87,950





This footer paragraph is an example only and should not be relied upon as complying with current legislation. These particulars, whilst believed to be accurate are set out as a general outline only for guidance and do not constitute any part of an offer or contract. Intending purchasers should not rely on them as statements of representation of fact, but must satisfy themselves by inspection or otherwise as to their accuracy. No person in this firms employment has the authority to make or give any representation or warranty in respect of the property.



This footer paragraph is an example only and should not be relied upon as complying with current legislation. These particulars, whilst believed to be accurate are set out as a general outline only for guidance and do not constitute any part of an offer or contract. Intending purchasers should not rely on them as statements of representation of fact, but must satisfy themselves by inspection or otherwise as to their accuracy. No person in this firm's employment has the authority to make or give any representation or warranty in respect of the property.

Grangemoor Close

Darlington DL1 4UW



- Terrace Property
- Ideal Investment

- Two Bedroom
- Council Tax Band B

- Off Street Parking
- No Chain

This well presented two bedroom terraced property is located within a quiet cul de sac on the Moorfields Development in Darlington, the home comes to the market with no onward chain. The property is well presented throughout and offers well proportioned living accommodation with kitchen/breakfast room, lounge, two bedrooms to the first floor and a family bathroom. Gardens to the front and rear with off street parking.

Viewing is recommended.

Entrance Hallway

Door to the front, staircase to the first floor and radiator.

Downstairs Cloakroom

Upvc double glazed window to the front, w/c and wash hand basin, radiator and vinyl flooring.

Kitchen

11'6 x 7'4 (3.51m x 2.24m)

Upvc double glazed window to the front, wall base and draw units with contrasting work surfaces, four ring gas hob, electric oven, integrated fridge freezer, space for washing machine and space for dryer, stainless steel sink unit, vinyl flooring and radiator.

Lounge / Diner

14'6 x 10'4 (4.42m x 3.15m)

Storage cupboard, radiator and two French patio doors to the rear.

First Floor

Landing, access to the loft area and radiator.

Bedroom One

14'6 x 8'8 (4.42m x 2.64m)

Two Upvc double glazed windows to the front, storage cupboard and radiator..

Bedroom Two

14'6 x 7'7 (4.42m x 2.31m)

Two Upvc double glazed windows to the rear and radiator.

Bathroom

Fitted with a white suite, panelled bath with shower over and screen, w/c, wash hand basin, part tiled walls, vinyl flooring, part tiled walls and radiator.

Externally

To the front is an open plan laid to lawn area and parking space for one vehicle.

To the rear the garden is mainly laid to lawn with a patio area.

Council Tax

Band B

Tenure

Freehold

Note

IMPORTANT NOTE TO PURCHASERS: We endeavour to make our sales particulars accurate and reliable, however, they do not constitute or form part of an offer or any contract and none is to be relied upon as statements of representation or fact. The services, systems and appliances listed in this specification have not been tested by us and no guarantee as to their operating ability or efficiency is given. All measurements have been taken as a guide to prospective buyers only, and are not precise. Floor plans where included are not to scale and accuracy is not guaranteed. If you require clarification or further information on any points, please contact us, especially if you are travelling some distance to view. Fixtures and fittings other than those mentioned are to be agreed with the seller. We cannot also confirm at this stage of marketing the tenure of this house

GROUND FLOOR

1ST FLOOR

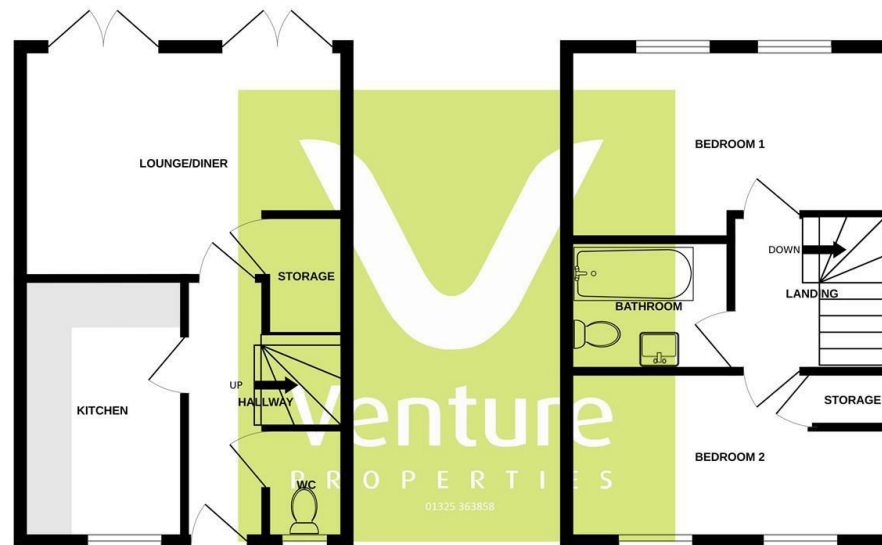

Whilst every attempt has been made to ensure the accuracy of the floorplan contained here, measurements of doors, windows, rooms and any other items are approximate and no responsibility is taken for any error, omission or mis-statement. This plan is for illustrative purposes only and should be used as such by any prospective purchaser. The services, systems and appliances shown have not been tested and no guarantee as to their operability or efficiency can be given.
Made with Metropix ©2023

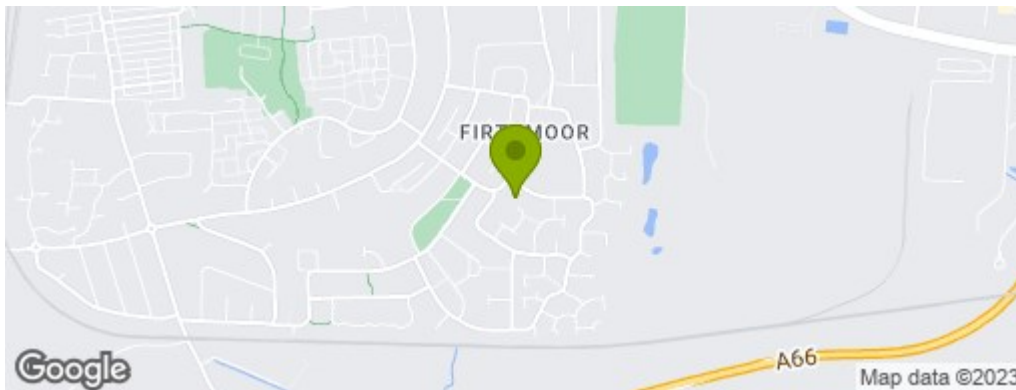

Property Information

01325 363858

45 Duke Street, Darlington, County Durham, DL3 7SD
sales@venturepropertiesuk.com